



# Joburg InDesign User Group

30th OCTOBER, 2008

Meeting Sponsors



## Proportional place

- layout images same as size, frame and content
- hold command/control + d to place images (remember one can select multiple images at once)
- check mouse pointer - (when white it is aligning)
- proportional place - with smart guides - green

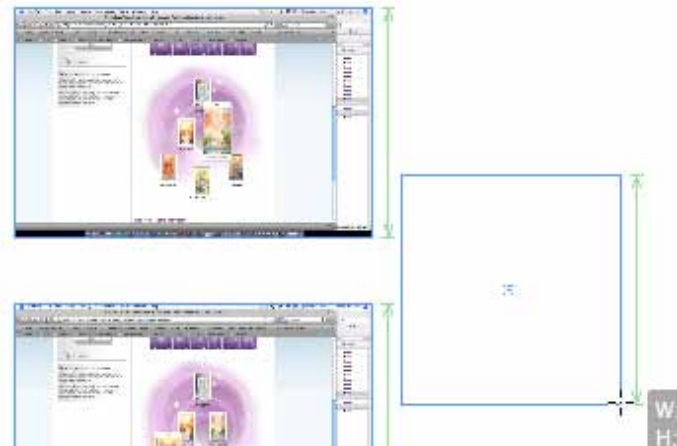

## Smart guides

- with selection tool and move - smart guides or smart spacing guides appear
- if using rotate tool - context panel will tell you - then select other image and smart guides

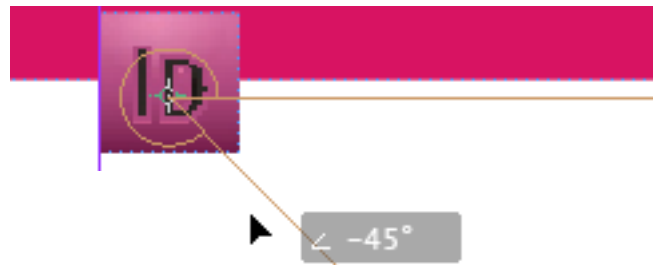

## Links

- display as thumbnails
- multi-instances of same link - now one row
- click on hyper link
- click thumbnail - opens link info
- panel options - to set options - ppi, scale ,
- "folder 0" = show me folder it is in
- new icons above - ascending - descending for sorting
- update to file with different extensions. eg jpg with tif

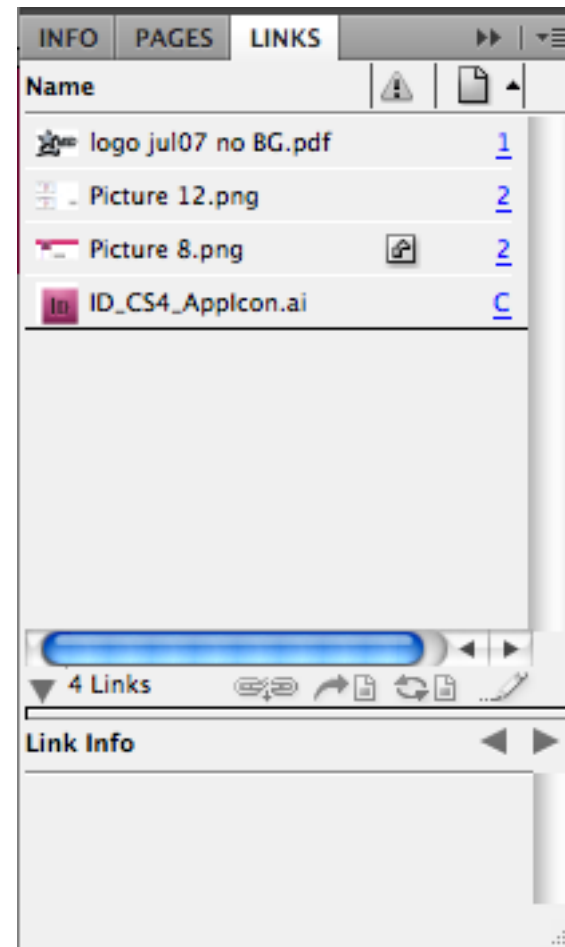

## rotation

- rotate spreads - right click in pages panel on spread - rotate spread view - only on screen - see icon
- rotation is saved with document
- also rotated in incopy as well in layout view - not able to change

## tables

- see overset text in a table - even in story editor
- InCopy can track changes in table cells

## Story editor

- split view to see edit layout and design view
- multiple story editor

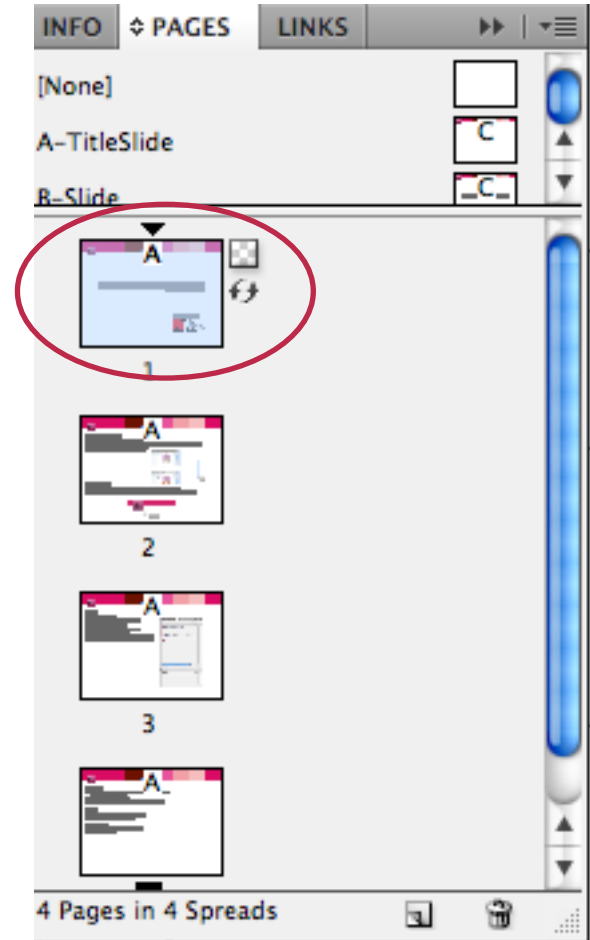

## Live Preflight

- basic profile by default
- double click widget
- navigate on hyper link for page or object
- create own profiles

## styles improvements

- new nestest line styles
- new GREP Styles - apply character style to Grep result
- type word - apply style

## Export to SWF

- points in IND = 1 pixel
- file> export> change settings
- no export for flash lite

